

FONDAZIONE: ARMATURA LONGITUDINALE

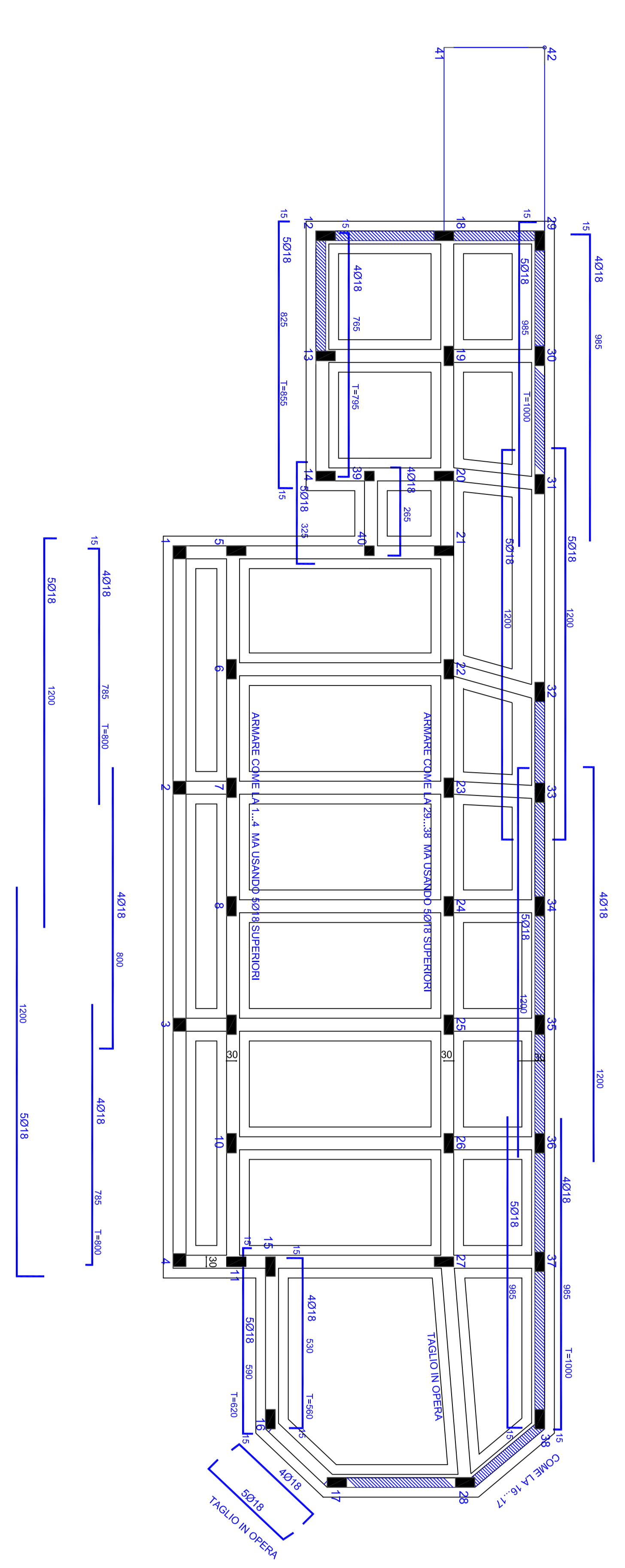

SECONDO SOLAIO: ARMATURA LONGITUDINALE

N.B.: STAFFE IN TUTTE LE TRAVATE: 108/10 NEL PRIMO METRO DALL'INCOSTRUIO IN CAMPATA 10/10/15

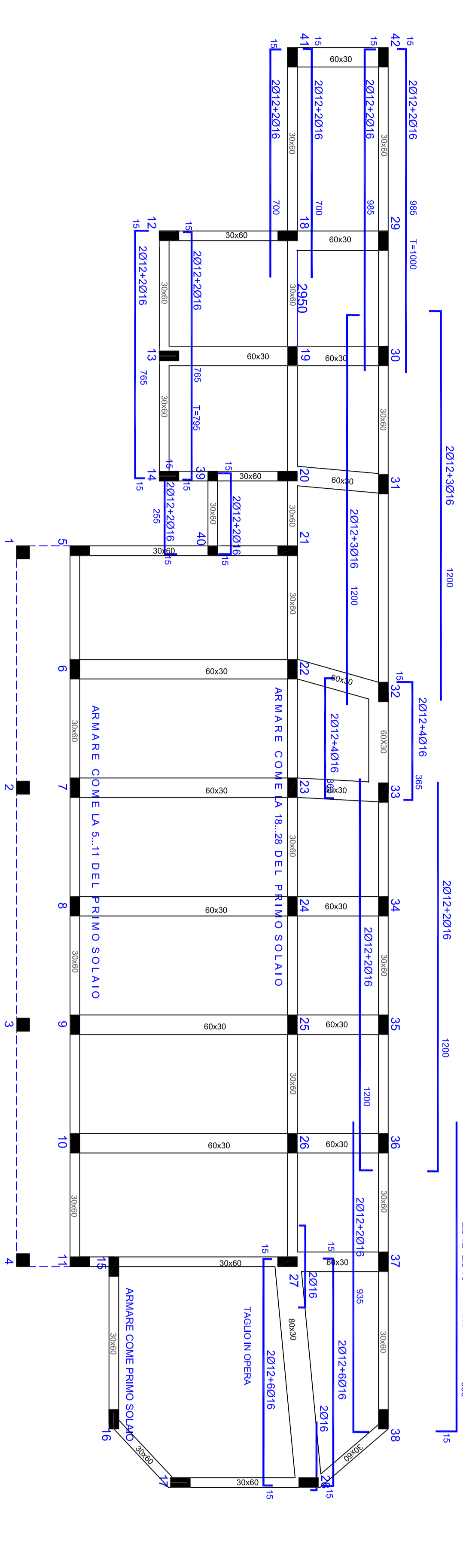

IDENTIFICAZIONE CORPI DI FABBRICA

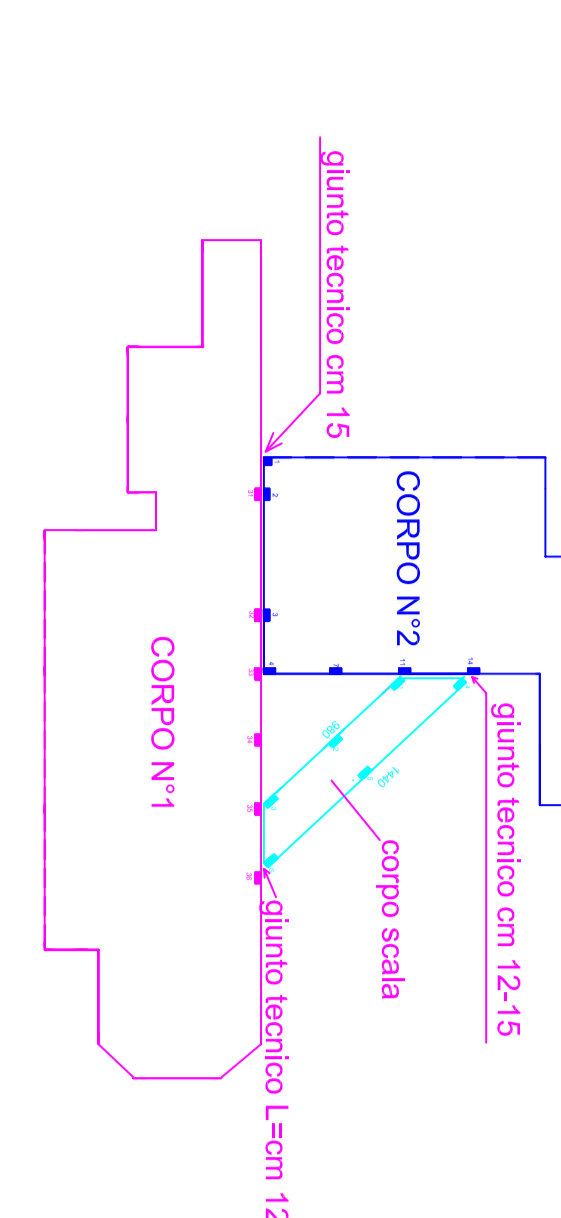

PRIMO SOLAIO: ARMATURA LONGITUDINALE

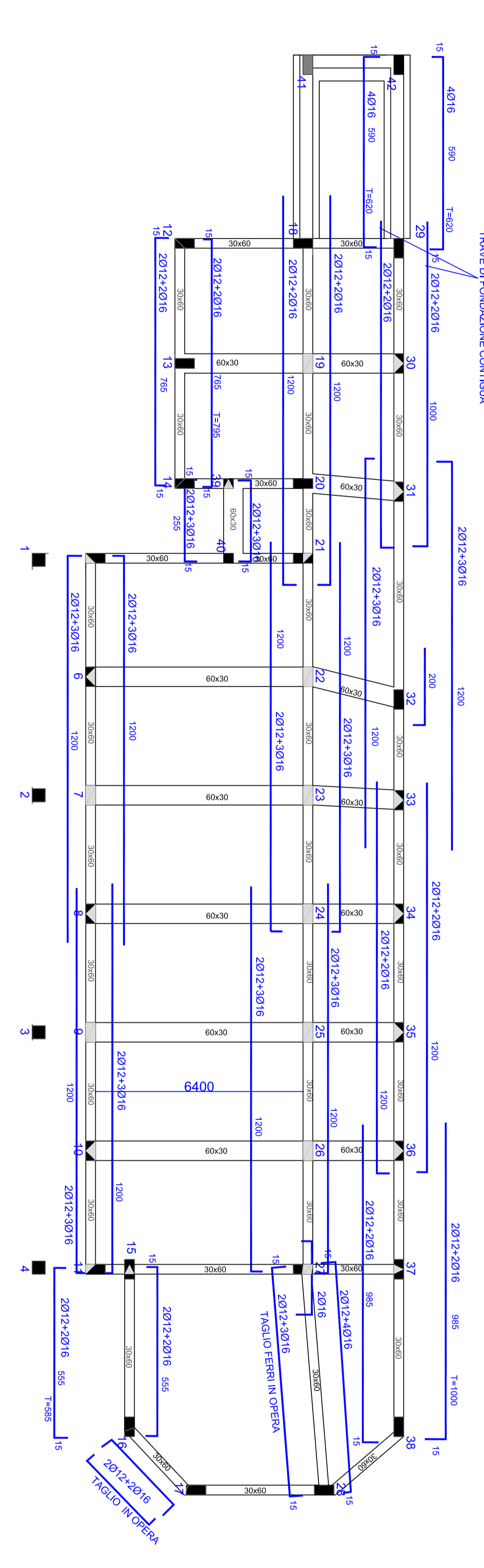

TERZO SOLAIO: ARMATURA LONGITUDINALE

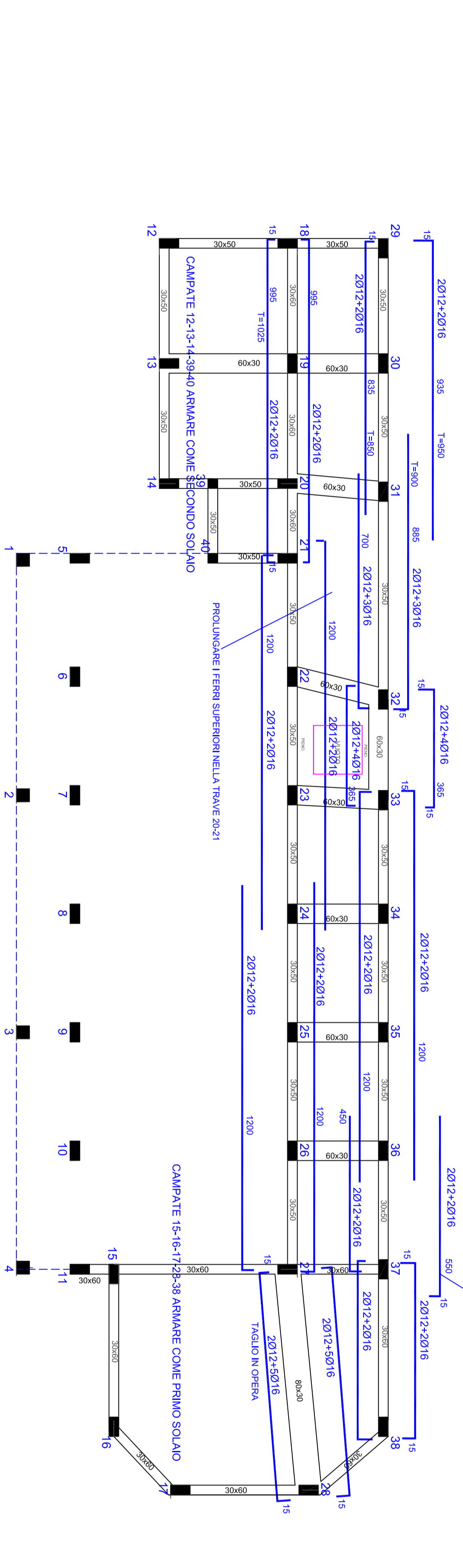

QUARTO SOLAIO: ARMATURA LONGITUDINALE

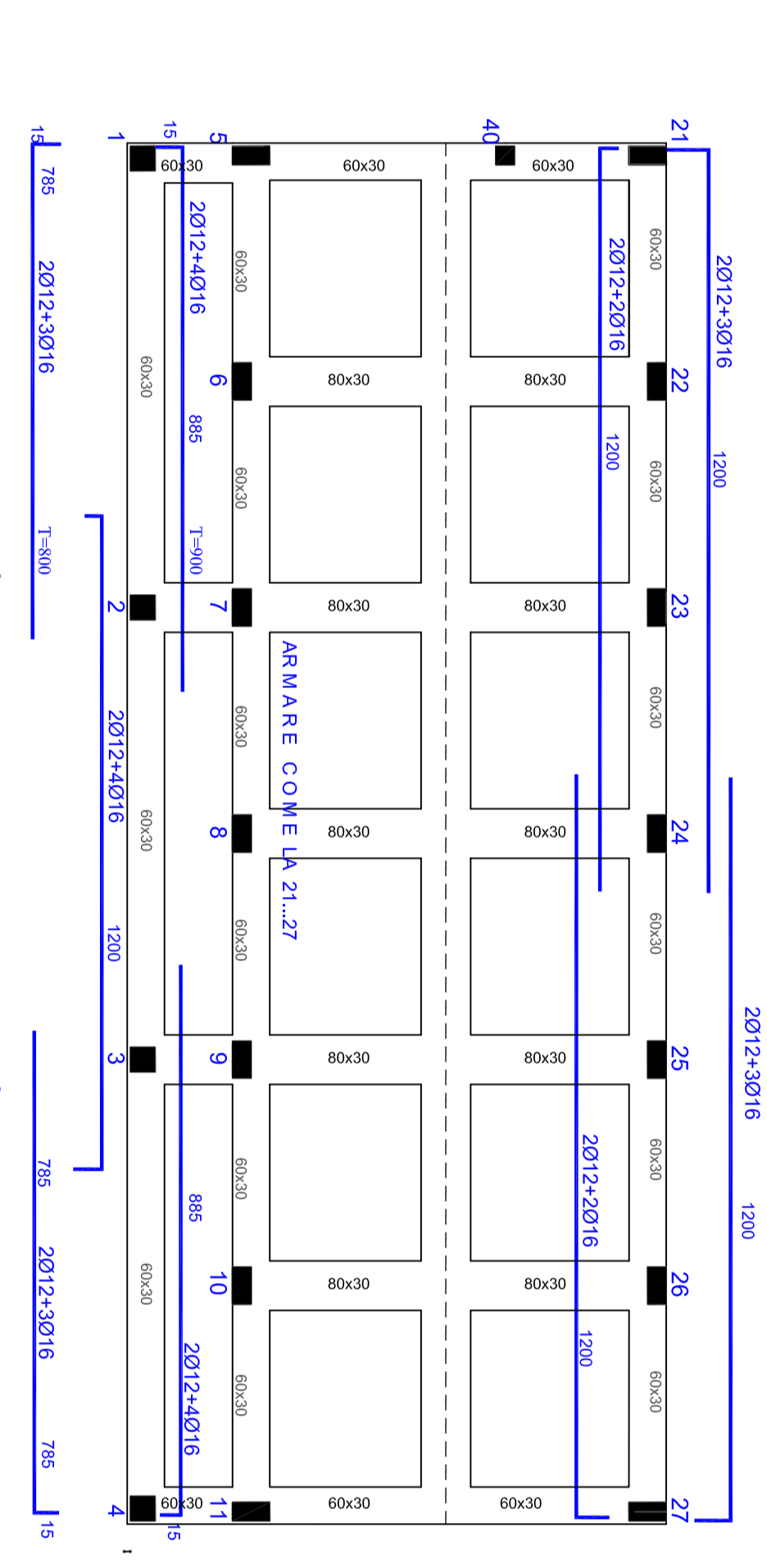

FONDAZIONE: ARMATURA TRASVERSALE

N.B.: STAFFE IN TUTTE LE TRAVATE: 10/10/10 NEL PRIMO METRO DALL'INCOSTRUIO IN CAMPATA 10/10/15

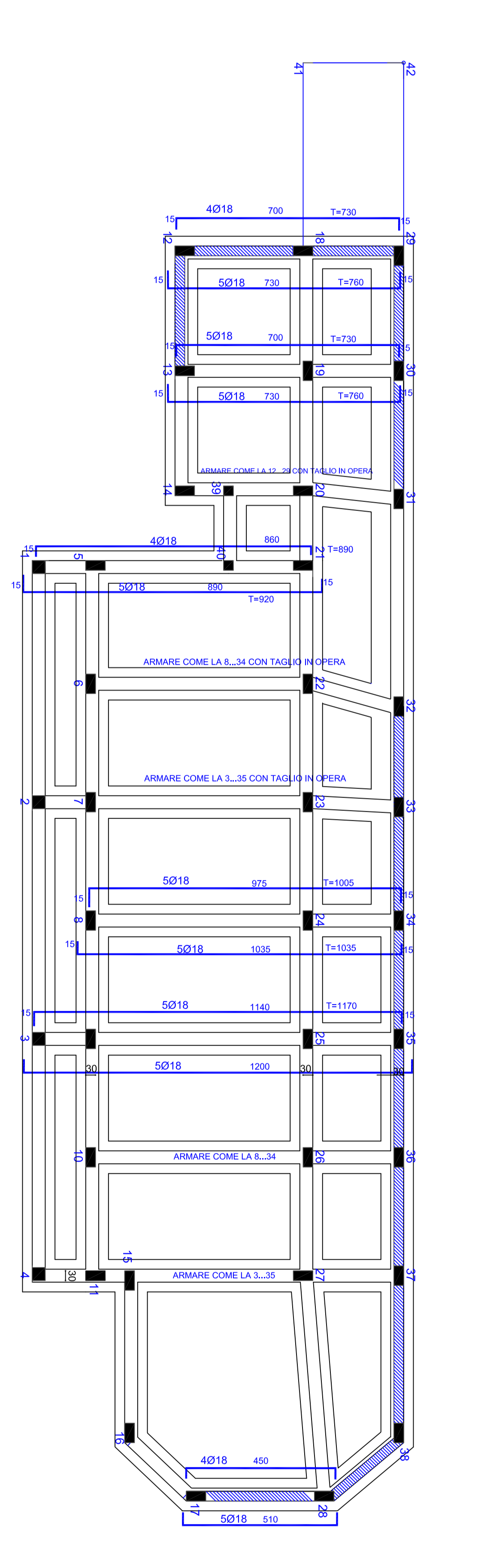

PRIMO SOLAIO: ARMATURA TRASVERSALE

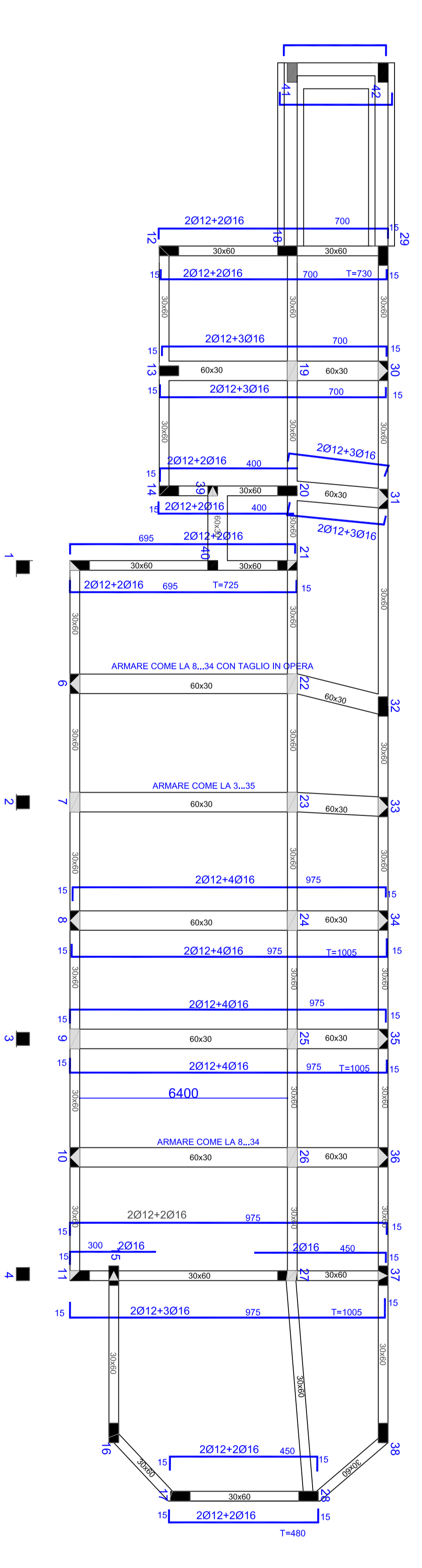

IDENTIFICAZIONE CORPI DI FABBRICA

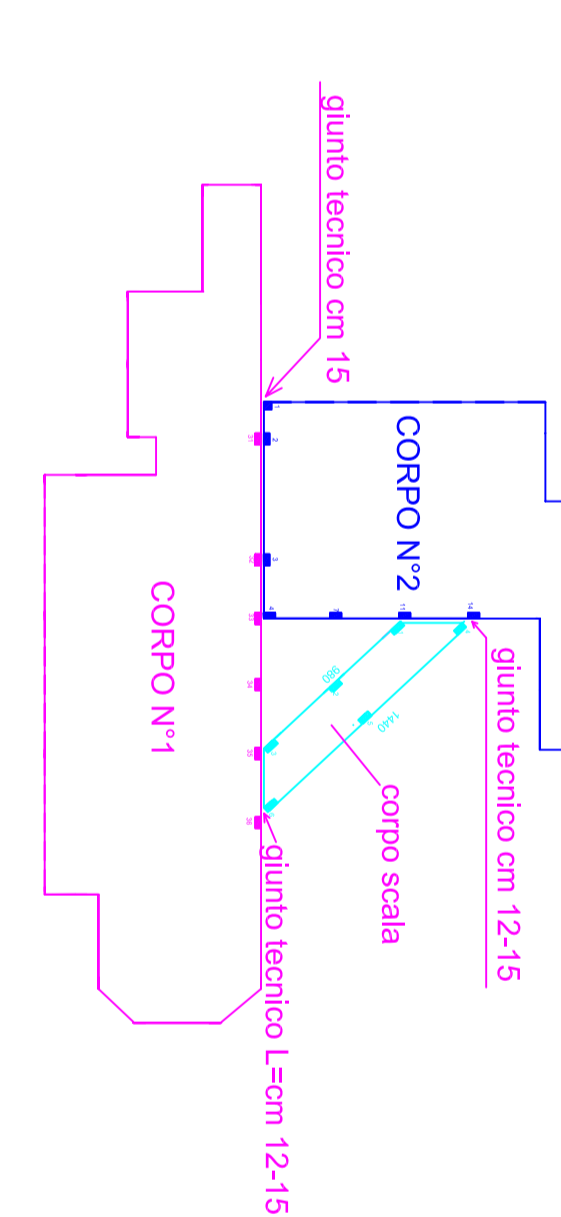

SECONDO SOLAIO: ARMATURA TRASVERSALE

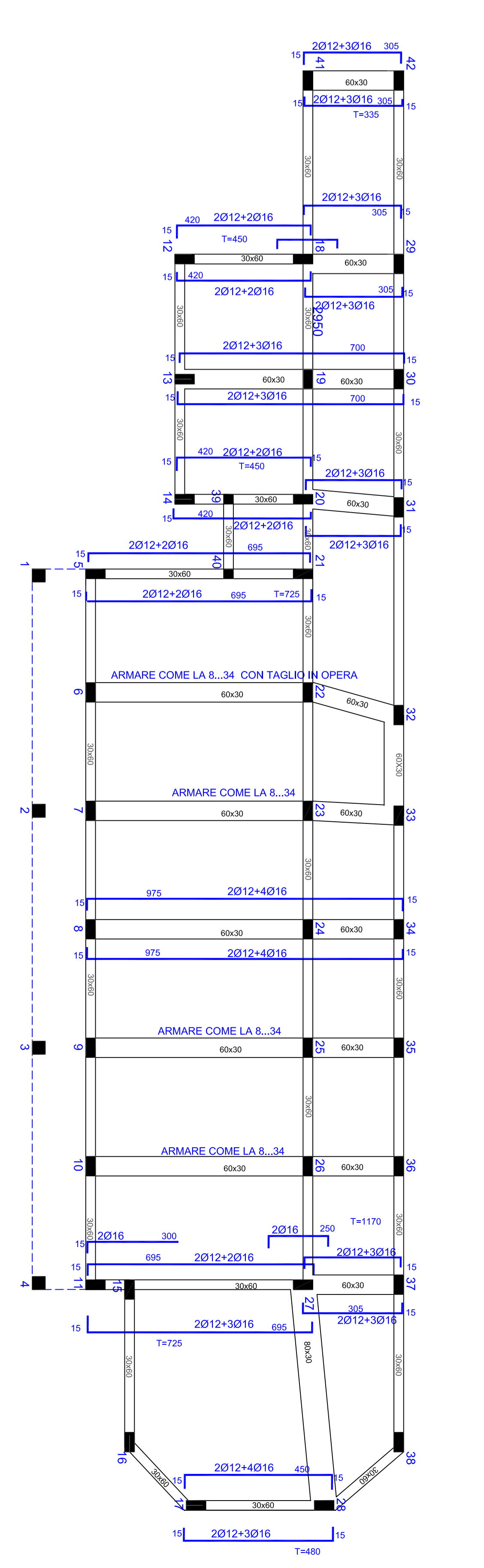

TERZO SOLAIO: ARMATURA TRASVERSALE

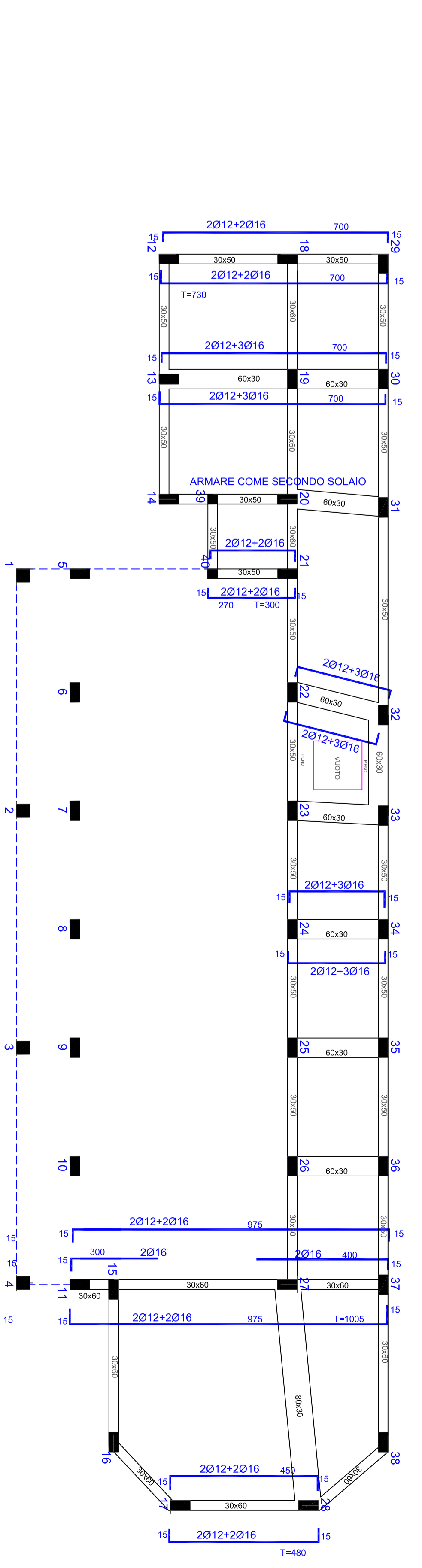

QUARTO SOLAIO: ARMATURA TRASVERSALE

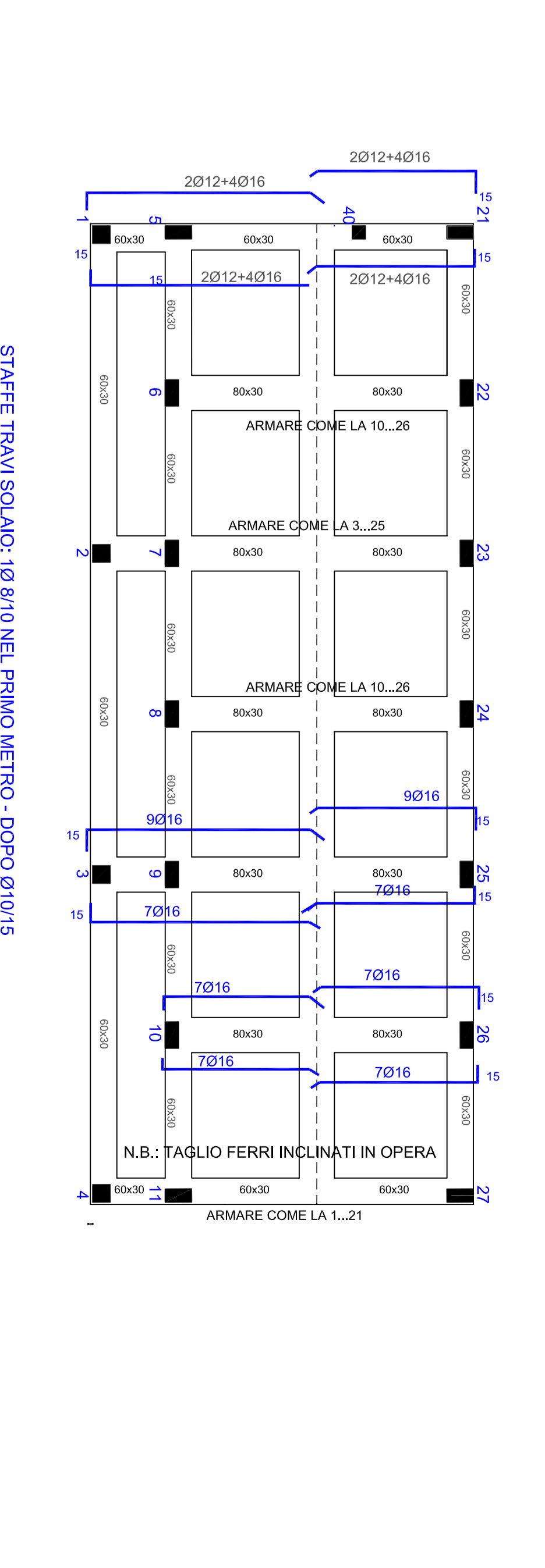

STAFFE TRAVI SOLAIO: 10/8/10 NEL PRIMO METRO - CORPO 01/01/5 SUL SOLAIO DISPORRE RETE ELETTROALIMENTA DA Ø8 - 20X20

STAFFE TRAVI SOLAIO: 10/8/10 NEL PRIMO METRO - CORPO 01/01/5 SUL SOLAIO DISPORRE RETE ELETTROALIMENTA DA Ø8 - 20X20

N.B.: TAGLIO FERRI INCLINATI IN OPERA